

**SITE PLAN**  
SCALE: 1" = 20'

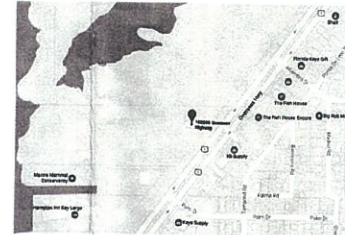

**LOCATION PLAN**  
SCALE: N.T.S

**LEGAL DESCRIPTION**

LOTS 1 AND 2, BLOCK 9, OF "ANGLERS PARK", ACCORDING TO THE PLAT THEREOF AS RECORDED IN PLAT BOOK 1, PAGE 159 OF THE PUBLIC RECORDS OF MONROE COUNTY, FLORIDA.

**SITE INFORMATION**

RE#: 00086730-000000  
AK#: 1095311  
ZONING: SUBURBAN COMMERCIAL (SC)  
TIER: 1 - NATIVE AREA  
FLUM: MIXED USE - COMMERCIAL (MG)  
ACRES: 0.37

**SCOPE OF WORK**

- REMOVE EXISTING TRACK LIGHTING IN DINING ROOM
- INSTALL LED LIGHTING IN DINING ROOM
- INSTALL NEW DROP CEILING
- NEW TILE ON BATHROOM FLOORS AND WALLS
- INSTALL ADA COMPLIANT GRAB BARS IN BATHROOMS

**STORMWATER RETENTION**

- NO NEW IMPERVIOUS AREA

**ENGINEER'S NOTES:**

TO THE BEST OF MY PROFESSIONAL KNOWLEDGE AND BELIEF, THE STRUCTURAL DESIGN COMPLIES WITH THE APPLICABLE SECTION OF THE FLORIDA BUILDING CODE AND ALL MONROE COUNTY APPLICABLE CODES.

MEANS AND METHODS OF CONSTRUCTION AND SAFETY PRECAUTIONS ARE THE RESPONSIBILITIES OF THE CONTRACTOR.

IT IS THE RESPONSIBILITY OF THE OWNER OR GENERAL CONTRACTOR TO VERIFY ALL NOTES, DIMENSIONS AND DESIGN OF THESE PLANS, PRIOR TO COMMENCEMENT OF WORK. IF ANY DISCREPANCIES SHALL ARISE, STOP WORK AND CONTACT ENGINEER IMMEDIATELY.

**CERTIFICATE OF COMPLIANCE**

I CERTIFY THIS BUILDING TO BE DESIGNED TO WITHSTAND 150 MPH WIND SPEED ACCORDING TO ASCE 7-10 AS REQUIRED BY THE FLORIDA BUILDING CODE. SEE STRUCTURAL SHEETS FOR OTHER DESIGN CRITERIA.

305-823-3737  
PABLO R. GARCIA P.E.  
CIVIL ENGINEER  
MIAMI LAKES, FLORIDA 33016  
7720 NW 146th STREET



RE# 00086730-000000







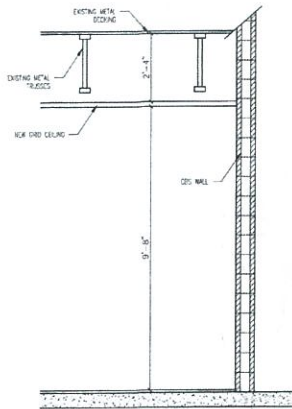





A REMODEL PLAN FOR:  
ALFREDO'S COUNTRY KITCHEN  
102250 OVERSEAS HIGHWAY  
KEY LARGO, FL 33037

DATE	1-30-17
BY	SHOWN
CHECKED	JB
SCALE	
SHEET NO.	1
TOTAL SHEETS	3

406 17 207  
2017-122



TYPICAL SECTION  
SCALE: 1/2" = 1'-0"

-  PENDANT LIGHT
-  110V DUPLEX RECEPTACLE
-  110V DUPLEX RECEPTACLE WITH GROUND FAULT INTERRUPTER
-  WALL MOUNTED LIGHT FIXTURE
-  SWITCH
-  SWITCH WITH DIMMER
-  THREE-WAY SWITCH
-  BATHROOM EXHAUST FAN
-  SMOKE DETECTOR
-  CEILING MOUNT LIGHT FIXTURE
-  RECESSED CEILING FIXTURE
-  DISCONNECT SWITCH
-  ELECTRICAL PANEL

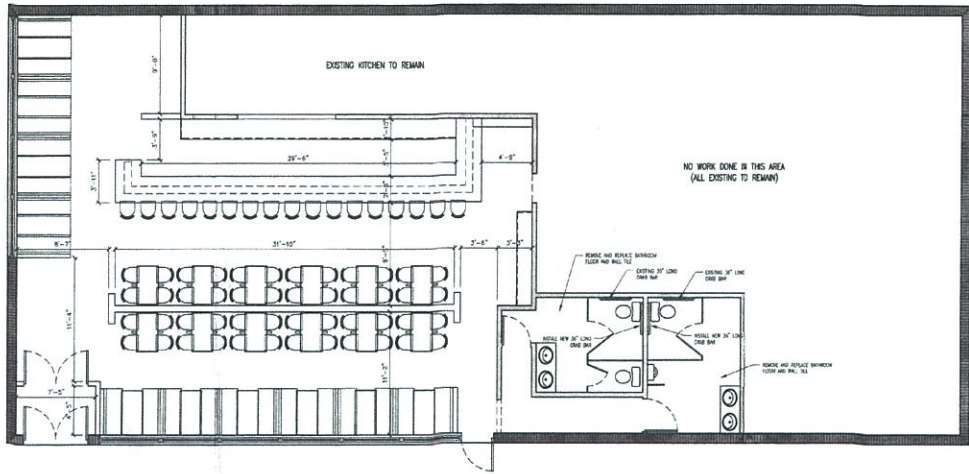

DINING ROOM LAYOUT  
SCALE: 3/16" = 1'-0"

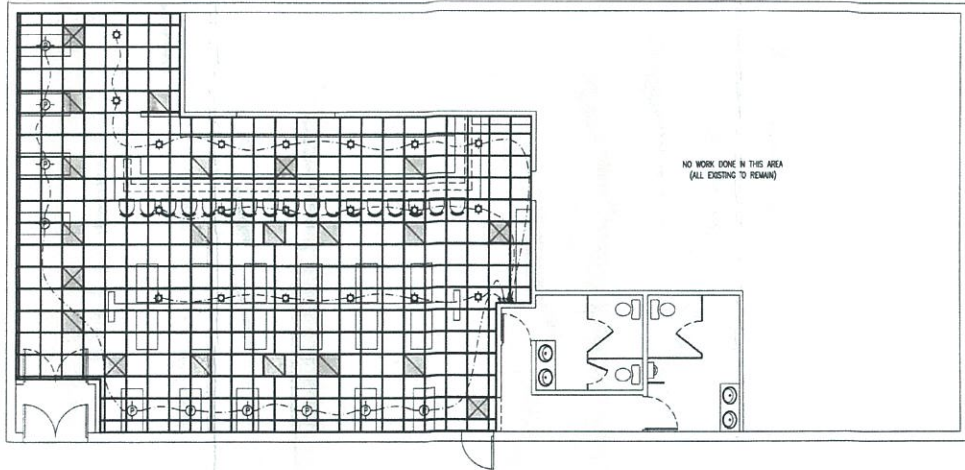

CEILING GRID & ELECTRICAL PLAN  
SCALE: 3/16" = 1'-0"

AUG 17 2017  
2017-132

RE# 00086750-000000  A REMODEL PLAN FOR: ALFREDO'S COUNTRY KITCHEN 102250 OVERSEAS HIGHWAY KEY LARGO, FL 33037	305-823-3737  PABLO R. GARCIA P.E. CIVIL ENGINEER 7729 NW 148th STREET MIAMI LAKES, FLORIDA 33016  
---	---

1-30-17	17
SHOWN	
BY	JB
DATE	
2	
OF 3	S-E-T-S